



**JK Rentals, Inc.**  
 P.O. Box 467  
 Kewaskum, WI 53040  
 Phone: 1-800-JKTENTS (558-3687)  
 Fax: 262-626-2780  
 Email: info@jkrentals.com



**Rental Order Form 2018** \*Pricing only good for duration of show

Forms received by June 1<sup>st</sup> will be given Early Bird Rate.

Forms received June 2<sup>nd</sup> through June 19<sup>th</sup> will be charged the Normal Rate.

Forms received June 20<sup>th</sup> through June 26<sup>th</sup> will be charged Last Chance Rate.

**NO MORE ORDERS WILL BE ACCEPTED AFTER JUNE 26<sup>TH</sup>.**

**Frame Tents 7' Legs** *Includes tent and sidewall.*

**Pole Tents 7' Legs** *Includes tent and sidewall*

Qty	Size	Early Bird Rate	Normal Rate	Last Chance Rate	Total
	10 x 10	\$400	\$600	\$800	
	15 x 15	\$500	\$750	\$1,000	
	15 x 25	\$570	\$855	\$1,140	
	20 x 20	\$685	\$1,028	\$1,370	
	20 x 30	\$840	\$1,260	\$1,680	
	20 x 40	\$1,064	\$1,596	\$2,128	

*For 9' Legs add additional 10% to rate*

Qty	Size	Early Bird Rate	Normal Rate	Last Chance Rate	Total
	30 x 30	\$1,064	\$1,596	\$2,128	
	30 x 45	\$1,495	\$2,243	\$2,990	
	30 x 60	\$1,740	\$1,283	\$3,480	
	40 x 40	\$1,610	\$2,415	\$3,220	
	40 x 60	\$2,415	\$3,623	\$4,830	
	40 x 80	\$3,000	\$4,500	\$6,000	

*For 9' Legs add additional 10% to rate*

**Tables and Chairs** *Table skirts and linens only available in black. Kwikcovers available in black or white.*

Qty	Description	Kwikcover Color	Early Bird Rate	Normal Rate	Last Chance Rate	Total
	8' x 30" Tables Standard Height	N/A	\$24	\$36	\$48	
	8' x 30" Tables Standard Height Skirted		\$42	\$63	\$84	
	6' x 30" Tables Standard Height	N/A	\$24	\$36	\$48	
	6' x 30" Tables Standard Height Skirted		\$42	\$63	\$84	
	8' x 30" Tables 42" Height Skirted		\$50	\$75	\$100	
	6' x 30" Tables 42" Height Skirted		\$50	\$75	\$100	
	60" Round Tables	N/A	\$28	\$42	\$56	
	30" Round 42" Height Skirted		\$50	\$75	\$100	
	30" Round 42" Height No Skirting	N/A	\$24	\$36	\$48	
	Folding Chairs		\$2.50	\$3.75	\$5.00	
	Tall Stools		\$20	\$30	\$40	

Lot No: \_\_\_\_\_

Or

Booth No: \_\_\_\_\_

**Special Request Section**

Upon talking to a representative of JK Rentals, Inc. about a special order and getting approval and pricing, write that information in the lines provided below and who gave you the authorization at JK Rentals, Inc.

---



---



---

**Tent Information**

Tents are flame retardant vinyl and include all necessary materials and labor; sidewall is also included. Many more sizes are available than what is listed. Please call us if you need other sizes. If you need your tent or equipment by a specific date before the show start date, please contact us to see if additional fees will occur based on the required set-up date. **You must circle on the map provided where your tent will be located and provide complete dimensions of the lot and exactly where you want the tent in feet from the North, South, East and West. Incorrect or not completed information will result in either your tent not being set up or an additional charge if your tent has to be moved.**



**JK Rentals, Inc.**  
 P.O. Box 467  
 Kewaskum, WI 53040  
 Phone: 1-800-JKTENTS (558-3687)  
 Fax: 262-626-2780  
 Email: info@jkrentals.com



## Rental Order Form Credit Card Authorization Form

**Company Name:** \_\_\_\_\_  
**Address:** \_\_\_\_\_  
**City/State/Zip:** \_\_\_\_\_  
**Phone: ( )** \_\_\_\_\_ **Fax: ( )** \_\_\_\_\_  
**Email:** \_\_\_\_\_  
**Equipment Ordered By (please print):** \_\_\_\_\_  
**Signature:** \_\_\_\_\_

This form must be returned with proper credit card authorization or a check for full amount in advance of form due date.  
 Subtotal: \_\_\_\_\_  
 5.5% ST: \_\_\_\_\_  
 Total: \_\_\_\_\_

=====

**Credit Card Authorization**      **Card Number:** \_\_\_\_\_  
**Circle One: Visa or MasterCard**      **Exp. Date:** \_\_\_\_\_ **CVV#:** \_\_\_\_\_  
**Card Holder Name:** \_\_\_\_\_      **Billing Zip:** \_\_\_\_\_

**Signature:** \_\_\_\_\_

**\* Discover and American Express are not accepted**

**\*A 25% deposit will be held if you cancel your order with less than a 2 weeks' notice of the event start date.**

-----

### Onsite Field Contact Information

**Company Name:** \_\_\_\_\_  
**Contact Name:** \_\_\_\_\_  
**Phone: ( )** \_\_\_\_\_ **Alternative Phone: ( )** \_\_\_\_\_  
**Email:** \_\_\_\_\_



**JK Rentals, Inc.**  
 P.O. Box 467  
 Kewaskum, WI 53040  
 Phone: 1-800-JKTENTS (558-3687)  
 Fax: 262-626-2780  
 Email: info@jkrentals.com



## Rental Order Form Tent Location

*\*This map should be used if you are placing tent on multiple lots in an 18 lot area.*

This must be filled out and returned. JK Rentals, Inc. will use the information that you supply to place the tent. If the information you supply is incorrect and if the tent needs to be moved additional charges will apply. On page 8 of this packet you must highlight on the map your lot(s). Please choose the layout that best fits your order.

The following information is required:

1. Lot number(s): \_\_\_\_\_
2. How many feet from the North of the lot? \_\_\_\_\_
3. How many feet from the South of the lot? \_\_\_\_\_
4. How many feet from the East of the lot? \_\_\_\_\_
5. How many feet from the West of the lot? \_\_\_\_\_
6. How many feet for length of lot(s) (North to South)? \_\_\_\_\_
7. How many feet for width of lot(s) (West to East)? \_\_\_\_\_

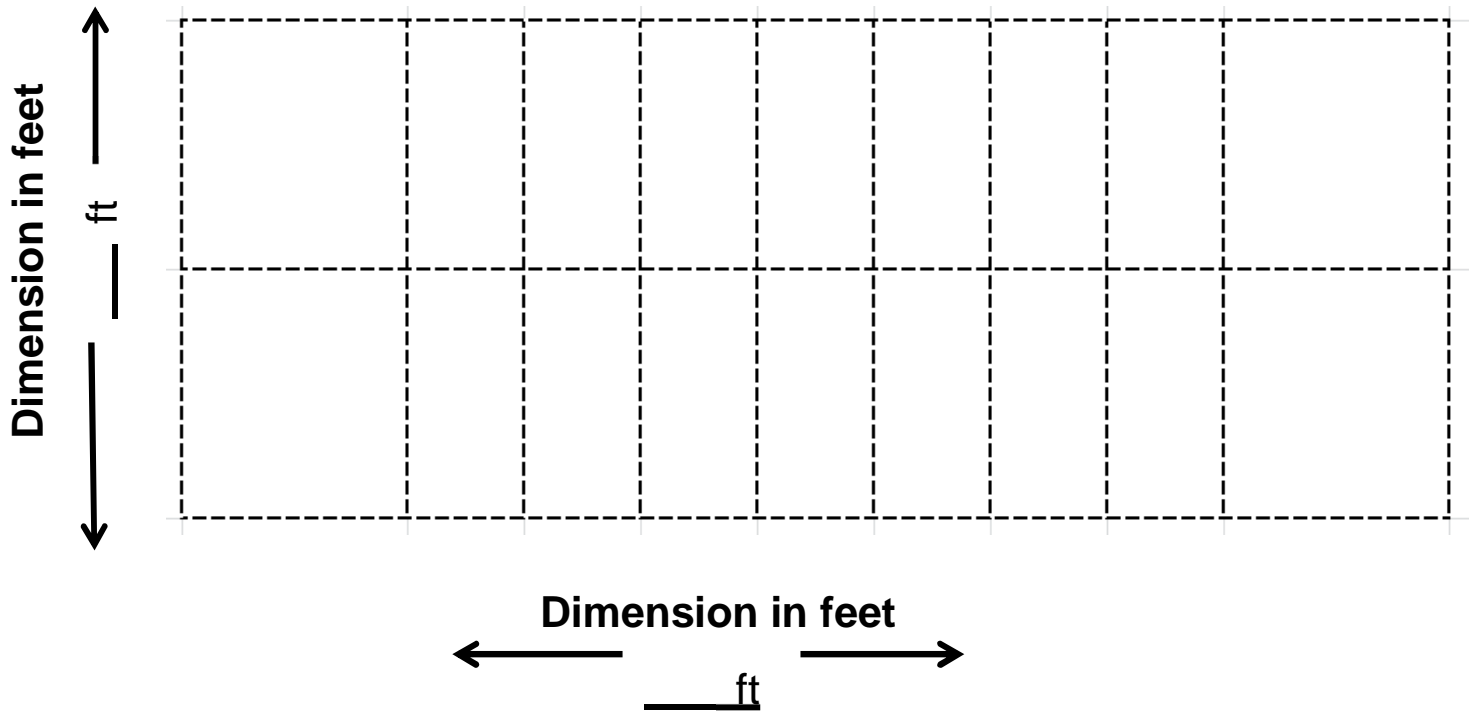
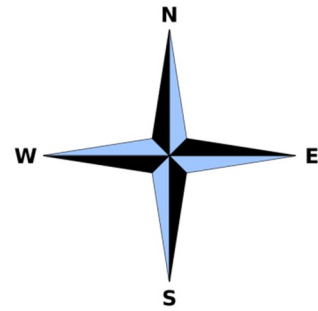



**JK Rentals, Inc.**  
 P.O. Box 467  
 Kewaskum, WI 53040  
 Phone: 1-800-JKTENTS (558-3687)  
 Fax: 262-626-2780  
 Email: info@jkrentals.com



## Rental Order Form Tent Location

\* This map should be used if you are placing tent on multiple lots in a 20 lot area.

This must be filled out and returned. JK Rentals, Inc. will use the information that you supply to place the tent. If the information you supply is incorrect and if the tent needs to be moved additional charges will apply. On page 8 of this packet you must highlight on the map your lot(s). Please choose the layout that best fits your order.

The following information is required:

1. Lot number(s): \_\_\_\_\_
2. How many feet from the North of the lot? \_\_\_\_\_
3. How many feet from the South of the lot? \_\_\_\_\_
4. How many feet from the East of the lot? \_\_\_\_\_
5. How many feet from the West of the lot? \_\_\_\_\_
6. How many feet for length of lot(s) (North to South)? \_\_\_\_\_
7. How many feet for width of lot(s) (West to East)? \_\_\_\_\_

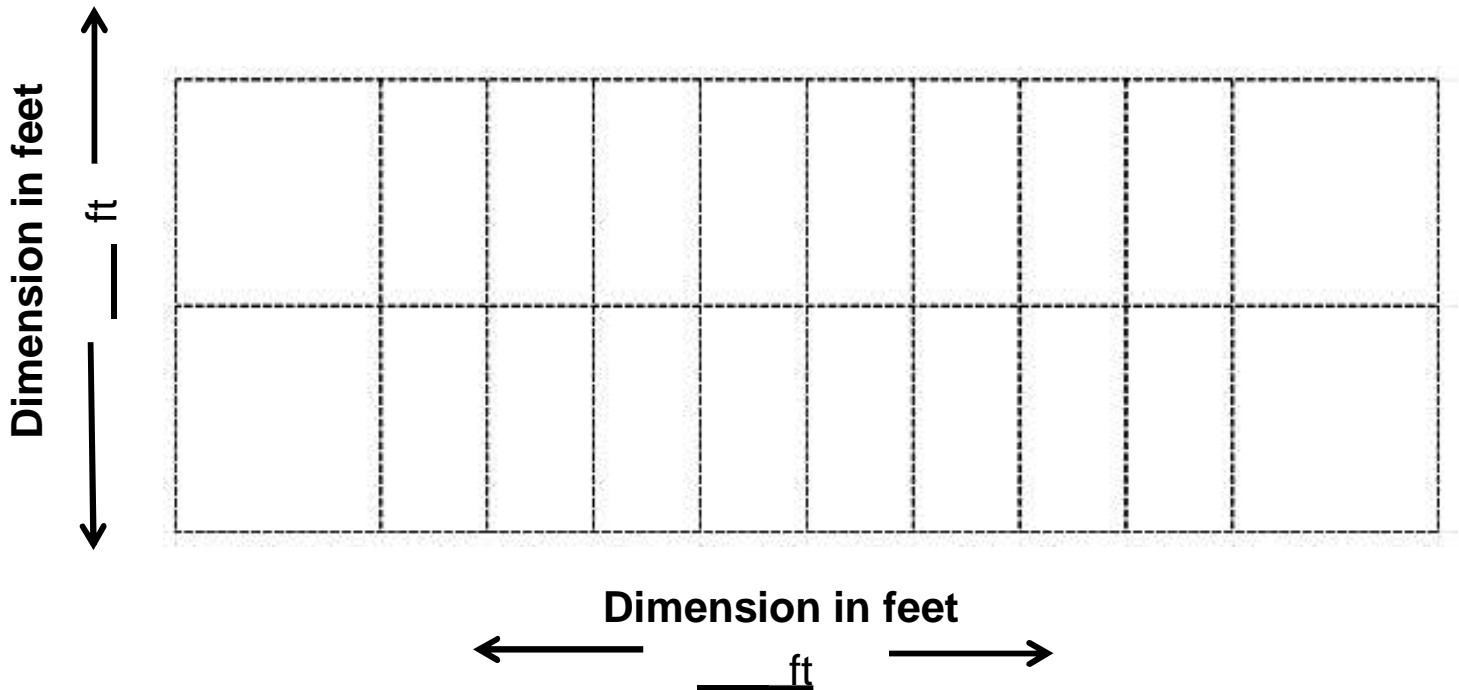
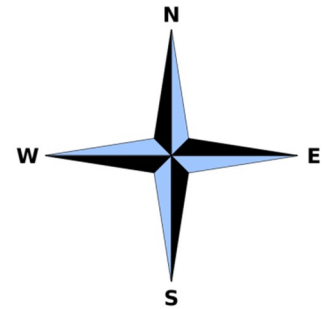



**JK Rentals, Inc.**  
 P.O. Box 467  
 Kewaskum, WI 53040  
 Phone: 1-800-JKTENTS (558-3687)  
 Fax: 262-626-2780  
 Email: info@jkrentals.com



## Rental Order Form Tent Location

\* This map should be used if you are placing tent on multiple lots in a 17 lot area.

This must be filled out and returned. JK Rentals, Inc. will use the information that you supply to place the tent. If the information you supply is incorrect and if the tent needs to be moved additional charges will apply. On page 8 of this packet you must highlight on the map your lot(s). Please choose the layout that best fits your order.

The following information is required:

1. Lot number(s): \_\_\_\_\_
2. How many feet from the North of the lot? \_\_\_\_\_
3. How many feet from the South of the lot? \_\_\_\_\_
4. How many feet from the East of the lot? \_\_\_\_\_
5. How many feet from the West of the lot? \_\_\_\_\_
6. How many feet for length of lot(s) (North to South)? \_\_\_\_\_
7. How many feet for width of lot(s) (West to East)? \_\_\_\_\_

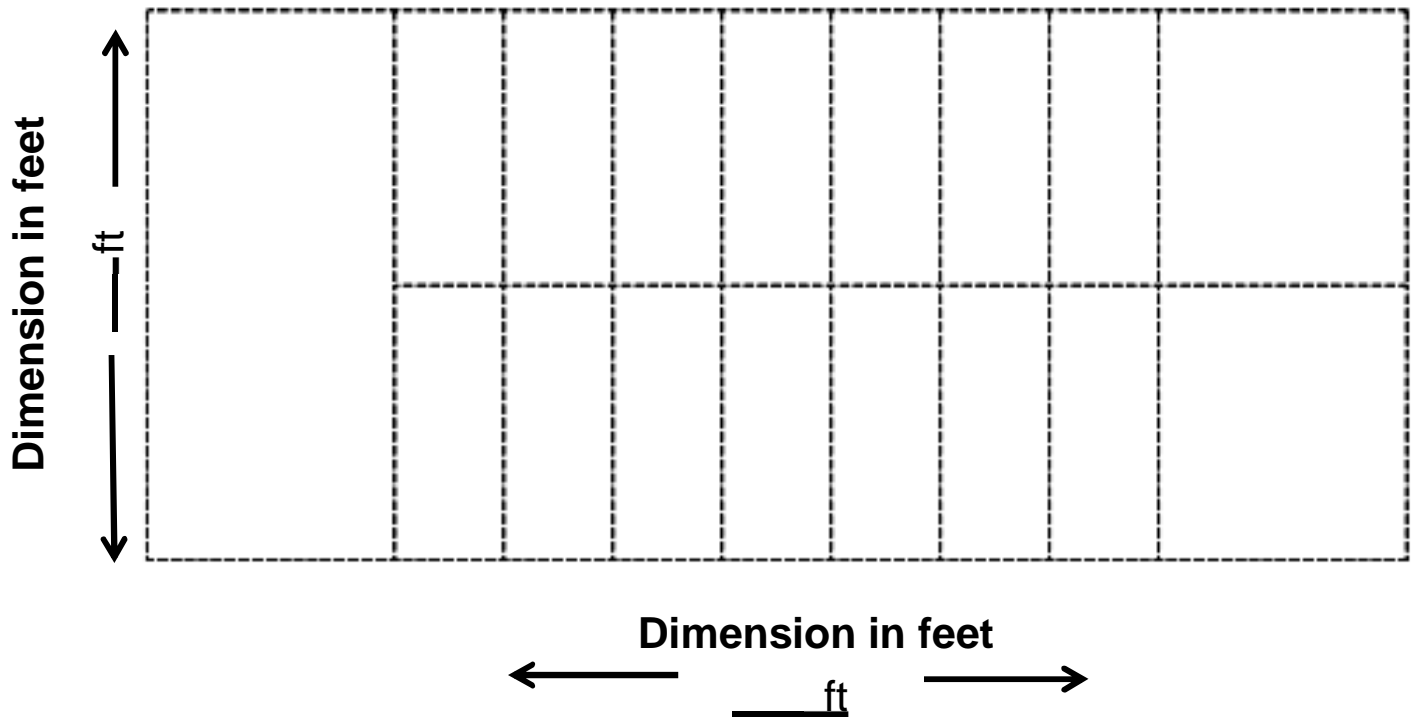
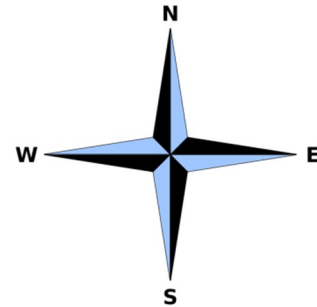



**JK Rentals, Inc.**  
 P.O. Box 467  
 Kewaskum, WI 53040  
 Phone: 1-800-JKTENTS (558-3687)  
 Fax: 262-626-2780  
 Email: info@jkrentals.com



## Rental Order Form Tent Location

\* This map should be used if you only have one tent in one rectangular lot.

This must be filled out and returned. JK Rentals, Inc. will use the information that you supply to place the tent. If the information you supply is incorrect and if the tent needs to be moved additional charges will apply. On page 8 of this packet you must highlight on the map your lot(s). Please choose the layout that best fits your order.

The following information is required:

1. Lot number(s): \_\_\_\_\_
2. How many feet from the North of the lot? \_\_\_\_\_
3. How many feet from the South of the lot? \_\_\_\_\_
4. How many feet from the East of the lot? \_\_\_\_\_
5. How many feet from the West of the lot? \_\_\_\_\_
6. How many feet for length of lot(s) (North to South)? \_\_\_\_\_
7. How many feet for width of lot(s) (West to East)? \_\_\_\_\_

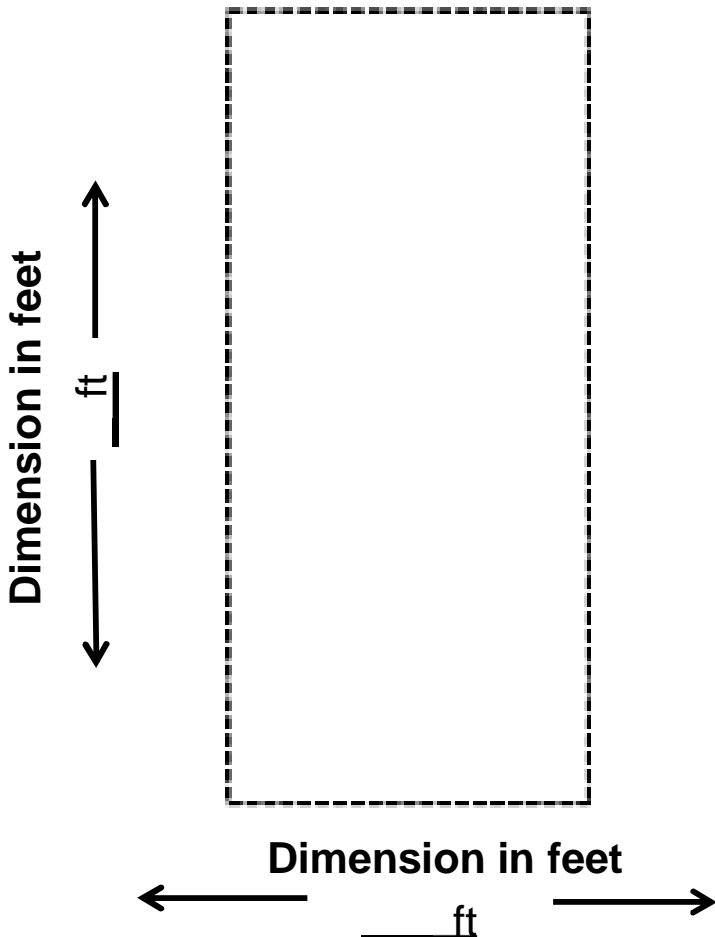
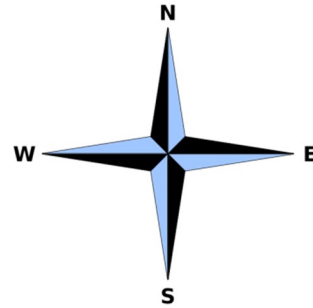



**JK Rentals, Inc.**  
P.O. Box 467  
Kewaskum, WI 53040  
Phone: 1-800-JKTENTS (558-3687)  
Fax: 262-626-2780  
Email: info@jkrentals.com



## Rental Order Form Tent Location

\* This map should be used if you only have one tent in one square lot.

This must be filled out and returned. JK Rentals, Inc. will use the information that you supply to place the tent. If the information you supply is incorrect and if the tent needs to be moved additional charges will apply. On page 8 of this packet you must highlight on the map your lot(s). Please choose the layout that best fits your order.

The following information is required:

1. Lot number(s): \_\_\_\_\_
2. How many feet from the North of the lot? \_\_\_\_\_
3. How many feet from the South of the lot? \_\_\_\_\_
4. How many feet from the East of the lot? \_\_\_\_\_
5. How many feet from the West of the lot? \_\_\_\_\_
6. How many feet for length of lot(s) (North to South)? \_\_\_\_\_
7. How many feet for width of lot(s) (West to East)? \_\_\_\_\_

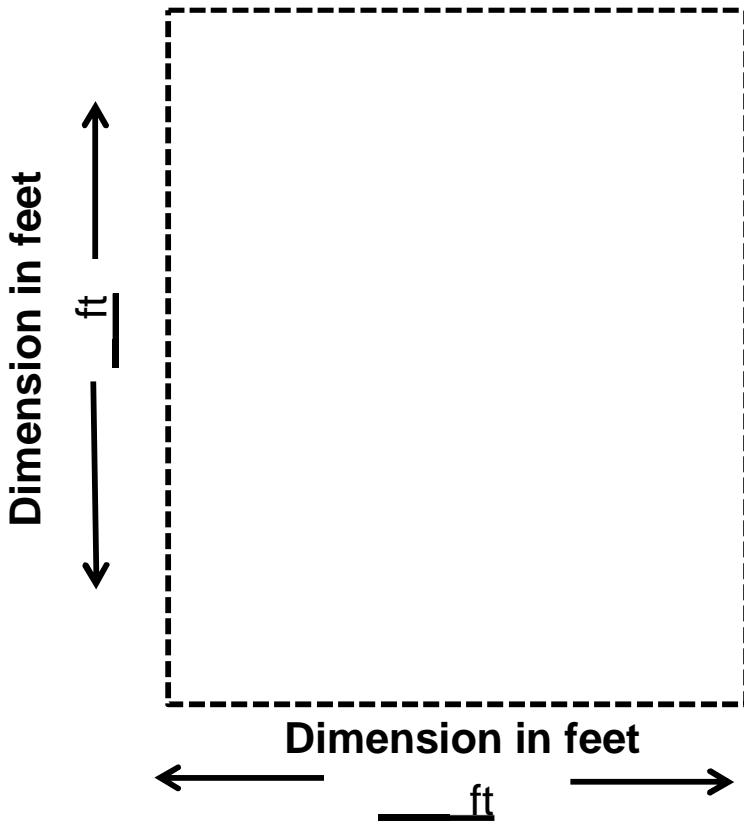
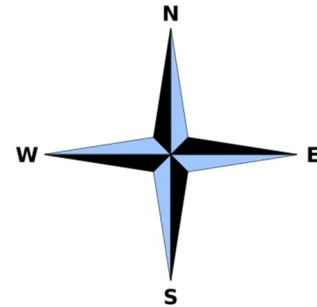



**JK Rentals, Inc.**  
 P.O. Box 467  
 Kewaskum, WI 53040  
 Phone: 1-800-JKTENTS (558-3687)  
 Fax: 262-626-2780  
 Email: info@jkrentals.com



# Rental Order Form

## Tent Location

